

SHARPHILL WOOD NATURE TRAIL FOR FAMILIES

On the following pages are some of the sights you are likely to see when you walk round the Wood. You enter Sharphill Wood at the North entrance (that's the West Bridgford end, marked Peveril entrance), through the gate & turn left at the first fork in the path on to footpath 32. Walk down this path as far as the Wheatcroft end and turned right towards the crossroads. Then you turn West towards footpath 31. You then walk northwards up path 31 till you reach path 30 which leads back to the Peveril entrance.

However the sights in the photos can be seen from all the paths. You can use the notes space at the end of this paper to record any interesting things you saw & post them on our FaceBook page to let other people know what you spotted?

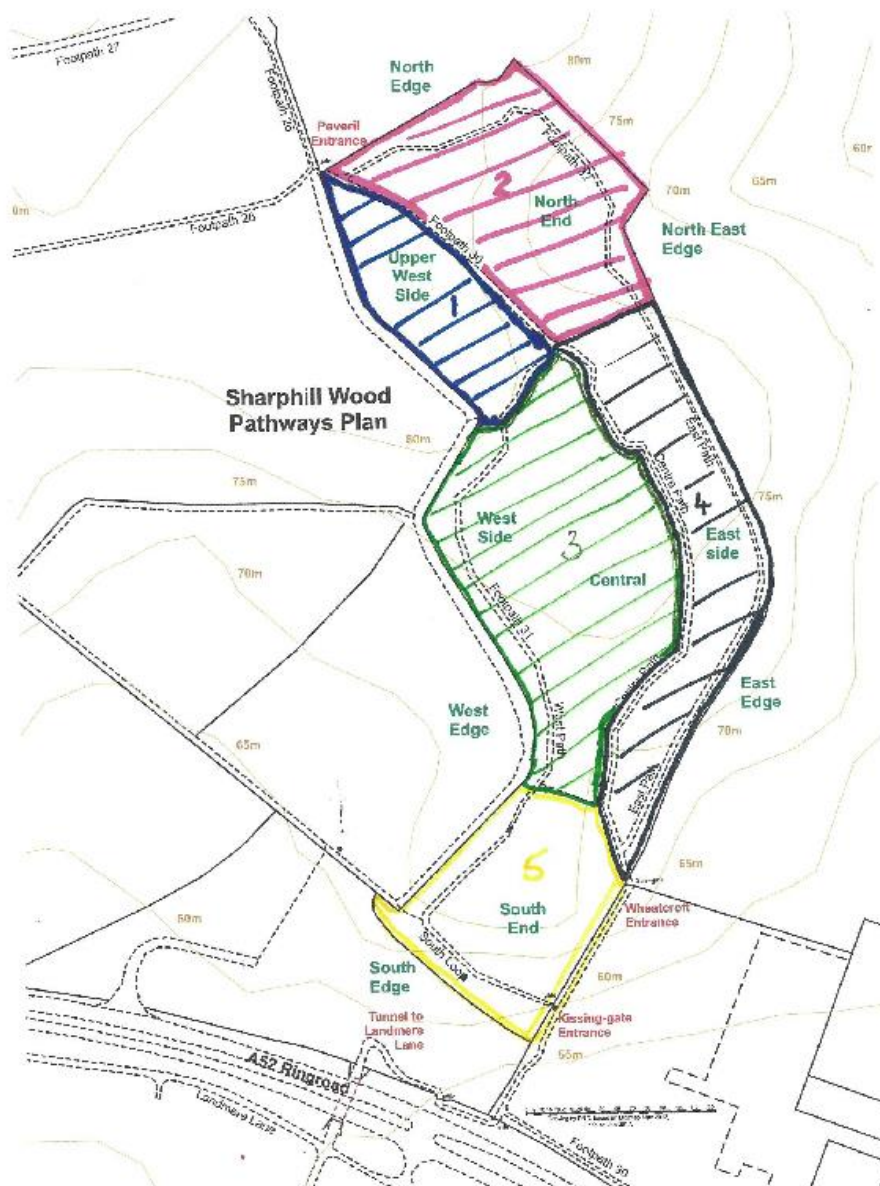



Here's the gate to Sharphill Wood
 Down the path lies all that's good.
 Trees and birds and flowers and moss
 Lots of things you'll come across
 Try to learn the names of trees
 Insects, butterflies and bees

(There's a Notice Board with Tree identification notes on it, just inside this gate!)

TREES



This English oak tree is in the Wood on the East path but there are many oaks throughout Sharphill Wood. Oak is used as a timber to make furniture & in building houses – in past times it was used to build ships. Can you spot the problem with this tree?

Can you recognise an oak by its acorns and its rutted bark
 Or its distinctive wavy leaves and grey brown twig with warty mark?

Number of oak trees seen (1 tick for each tree)



A fallen tree, a common sight, It once grew up into the light
 The roots grew weak, and strong winds came and blew it over, such a shame.
 It once was home to bird and bat, Now fungi and insects have a habitat! Whoopee!



Another prickly friend you'll see,
 At Christmas it could be
 Ablaze with berries red and bright,
 The tree they call holly.
 It makes a splendid hedging plant to keep out man and beast
 And when the berries have appeared it makes the birds a feast

Number of holly trees seen and whether they have red
 berries _____

The bird in the photo that you see, goes by the name of Jeremy.
 He's just a toy that's made of fur, just like a green woodpecker!

FUNGUS



This is a shaggy parasol mushroom. You must never eat fungi you find unless an expert has identified it as edible. Sharphill Wood has fungi of many types throughout the year growing in the rich soil formed by trees rotting.

Shady woodland hosts all sorts
Of fungus growing in the shade
See how many you can spot
Fallen trees begin to rot
See the habitat they've made
Mushrooms are a tasty treat
But till you're expert DO NOT EAT!

Describe some types of fungus you spot in the Wood



**This is coral, but not beneath the sea
It's coral spot fungus on the trunk of a dead tree
Count how many times this common fungus you can see**

Coral Spot fungus sightings_____

BIRDS

**Feathers lie on the forest floor
But the bird has many more
See how many you can find
See if you can guess the kind
From the colour and the size
Guessing will not win a prize!**

Numbers of feathers found (Tick for each feather or collect them)_____

Can you tell what type of birds they are? Write them down below



On the ground beneath the trees the Autumn leaves fall yearly
They pile and rot, creating soil that's rich, you can see clearly
The nutrients the soil contains is washed down to the roots
The trees take in this nourishment for leaves and seeds and fruits
Although it's good for gardens too, you must not take it away
For leaf mould helps the trees grow big, and stronger every day.

Did you find any leaf mould?



Look for ivy - you will find, an ivy tree cannot be climbed!
Ivy clings to ground and trees, small rootlets cling on where they please
Climbing up into the light, hiding insects from your sight

Could you find any insects hiding in the ivy?_____

What were they?_____

Hedges



The Wood is like an island and the fauna cannot pass
With ease across the open land where there is only grass
It's better when the hedgerows stretch between the woods and trees
Then creatures freely wider roam with safety and with ease

Do you know what the word fauna means? (See next page)

The hedge in the photo is actually an oak that has not been allowed to grow into a big tree! It is on the left as you approach the Peveril entrance.

BRAMBLES



Grasping this plant will give you pain!
But in the Autumn you will see
Purple berries juicy, sweet
It is the fruitful blackberry!

Did you see any flowers or fruit on the brambles?_____

"Fauna" means animals. Sharphill Wood contains animals, plants, flowers, trees, insects and other invertebrates (that means anything without a spine such as snails, spiders, ants and bees)

NOTES FROM OUR WALK IN SHARPHILL WOOD:-

(Don't forget to enter anything exciting on to Facebook)